

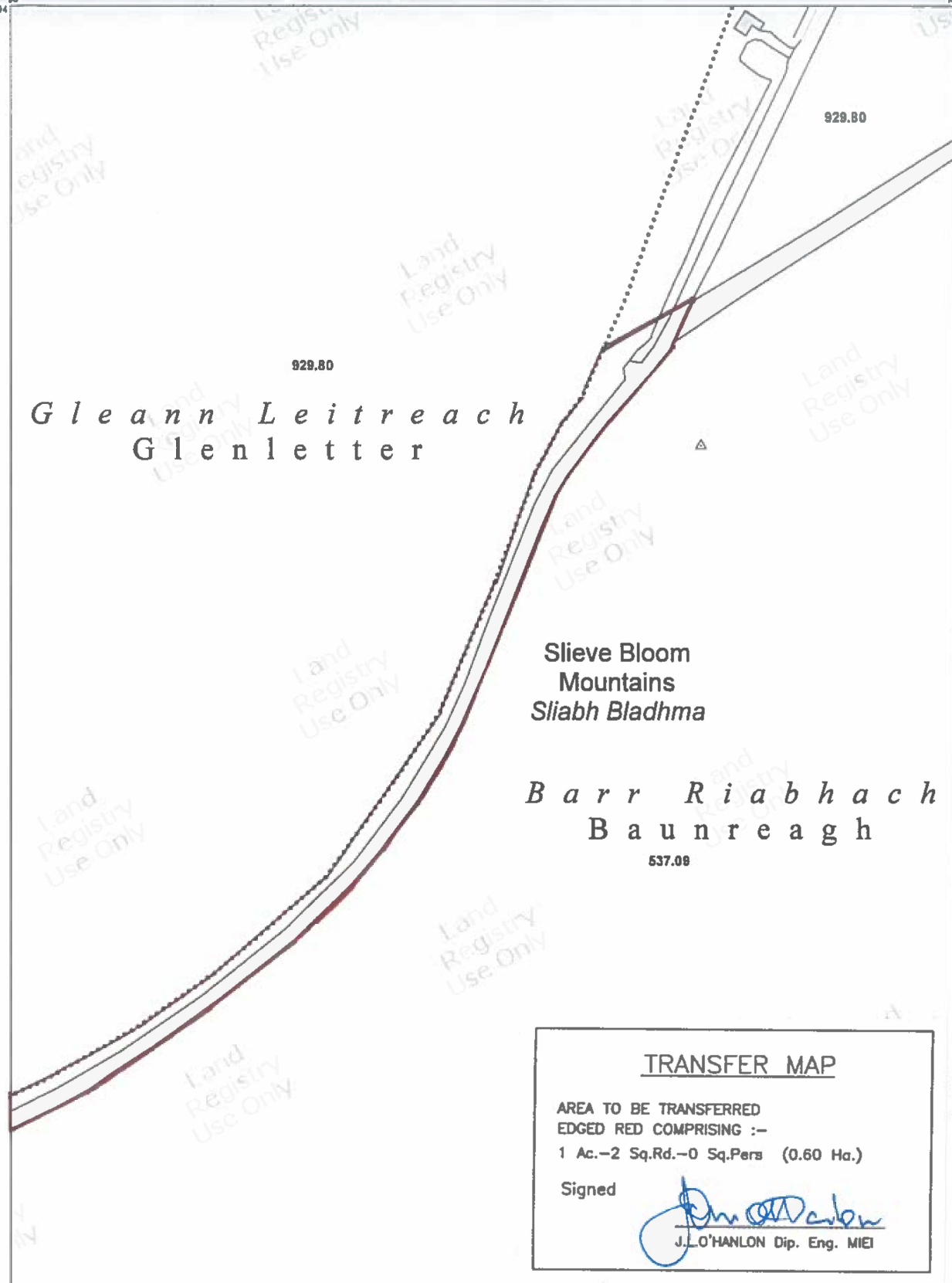

Land Registry Compliant Map



TRANSFER MAP

AREA TO BE TRANSFERRED
 EDGED RED COMPRISING :-
 1 Ac.-2 Sq.Rd.-0 Sq.Pers (0.60 Ha.)

Signed 
 J. O'HANLON Dip. Eng. MIEI

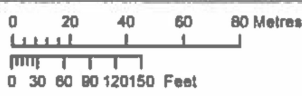

OUTPUT SCALE: 1:2,500



CENTRE COORDINATES:
 ITM 827187,704703

PUBLISHED: 21/03/2019
 MAP SERIES: 1:5,000

ORDER NO.: 50053148_1
 MAP SHEETS: 3822

CAPTURE RESOLUTION:
 The map objects are only accurate to the resolution at which they were captured. Output scale is not indicative of data capture scale. Further information is available at: <http://www.osi.ie>; search 'Capture Resolution' **LEGEND:** <http://www.osi.ie>; search 'Large Scale Legend'

COMPILED AND PUBLISHED BY: Ordnance Survey Ireland, Phoenix Park, Dublin 8, Ireland.

All rights reserved. No part of this publication may be copied, reproduced or transmitted in any form or by any means without the prior written permission of the copyright owners.

Ordnance Survey maps never show legal property boundaries, nor do they show ownership of physical features.

© Suirbhéireacht Ordnáis Éireann, 2019
 © Ordnance Survey Ireland, 2019
www.osi.ie/copyright

Unauthorised reproduction infringes Ordnance Survey Ireland and Government of Ireland copyright.

The representation on this map of a road, track or footpath is not evidence of the existence of a right of way.



Land Registry Compliant Map

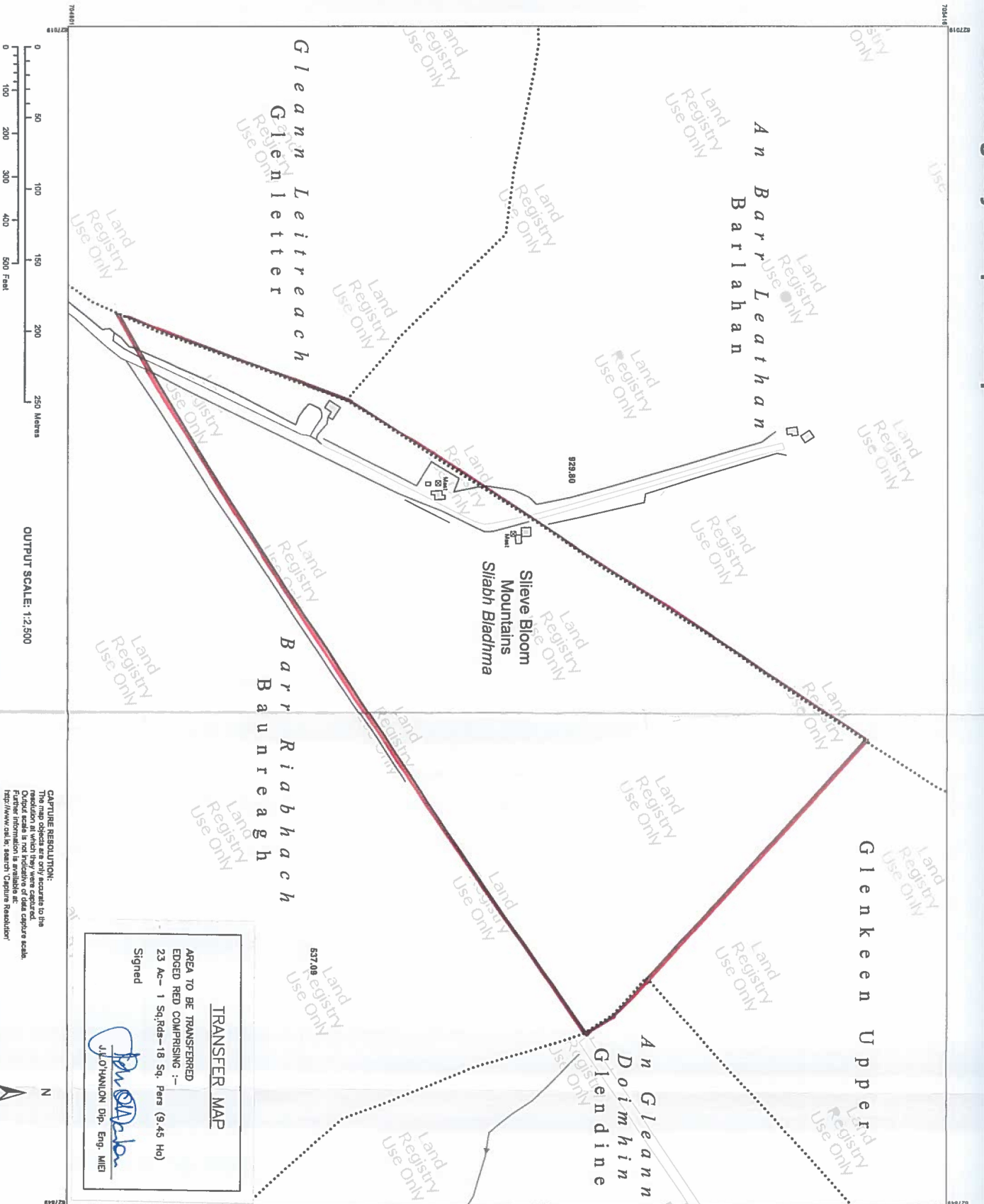

OUTPUT SCALE: 1:2,500

CAPTURE RESOLUTION:
The map objects are only accurate to the resolution at which they were captured. Output scale is not indicative of data capture scale. http://www.osi.ie/sectors/capture-resolution/

TRANSFER MAP
AREA TO BE TRANSFERRED
EDGED RED COMPRISING :-
23 Ac - 1 Sq.Rds - 18 Sq. Pasa (9.45 Ha)
Signed
J. O'Hanlon
J. O'HANLON Dip. Eng. MIEI



CENTRE COORDINATES:
ITM 827434,705109

PUBLISHED: 22/11/2018
ORDER NO.: 50038211_1

MAP SERIES: 1:5,000 3764
1:5,000 3822

COMPILED AND PUBLISHED BY:
Ordnance Survey Ireland,
Phoenix Park,
Dublin 8,
Ireland.

Unauthorized reproduction infringes Ordnance Survey Ireland copyright.

All rights reserved. No part of this publication may be reproduced, stored in a retrieval system or by any means without the prior written permission of the copyright owners.

The representation on this map of a road, track or footpath is not evidence of the existence of a right of way.

Ordnance Survey maps never show legal property boundaries, nor do they show ownership of physical features.

©Súirbhíreacht Ordánaité Éireann, 2018
©Ordnance Survey Ireland, 2018
www.osi.ie/copyright

LEGEND:
<http://www.osi.ie/search/LargeScaleLegend/>

Land Registry Compliant Map

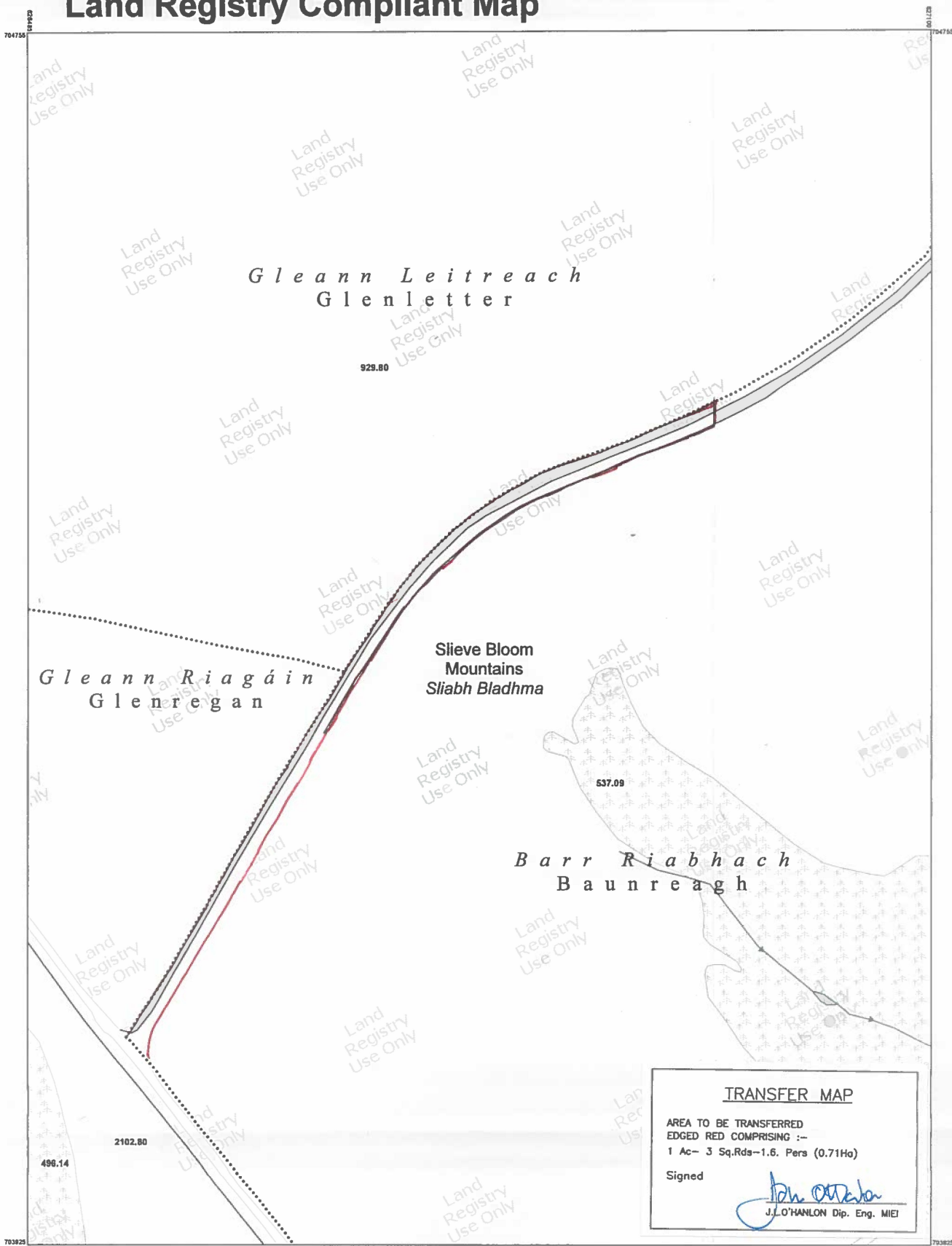

TRANSFER MAP

AREA TO BE TRANSFERRED
 EDGED RED COMPRISING :-
 1 Ac- 3 Sq.Rds-1.6. Pers (0.71Ho)

Signed 
 J.J. O'HANLON Dip. Eng. MIEI

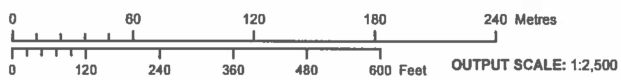

CENTRE COORDINATES:
 ITM 626793,704340

ORDER NO.: 50053144_1
PUBLISHED: 21/03/2019

©Suirbhéireacht Ordánáis Éireann, 2019
 ©Ordnance Survey Ireland, 2019
www.osi.ie/copyright

CAPTURE RESOLUTION:
 The map objects are only accurate to the resolution at which they were captured.
 Output scale is not indicative of data capture scale.
 Further information is available at:
<http://www.osi.ie>; search 'Capture Resolution'

LEGEND:
<http://www.osi.ie>; search 'Large Scale Legend'

COMPILED AND PUBLISHED BY:
 Ordnance Survey Ireland,
 Phoenix Park,
 Dublin 8,
 Ireland.

All rights reserved.
 No part of this publication may be copied, reproduced or transmitted in any form or by any means without the prior written permission of the copyright owners.

Ordnance Survey maps never show legal property boundaries, nor do they show ownership of physical features.

MAP SERIES:
 1:5,000

MAP SHEETS:
 3822

Unauthorised reproduction infringes Ordnance Survey Ireland and Government of Ireland copyright.

The representation on this map of a road, track or footpath is not evidence of the existence of a right of way.

